

CADET



1. From the breaker panel, turn off the power to the heater.



2. Check the heater's thermostat to ensure there is no power.



3. Remove the magnetic decorative cover.



4. Remove the grill that is secured with a screw.

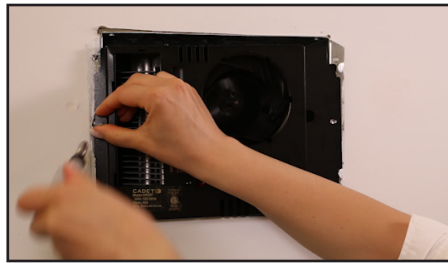

5. Remove the screw on the heater assembly and carefully remove it from the wall can.

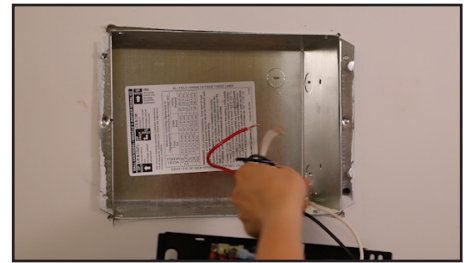

6. Disconnect the wires from the original heater.

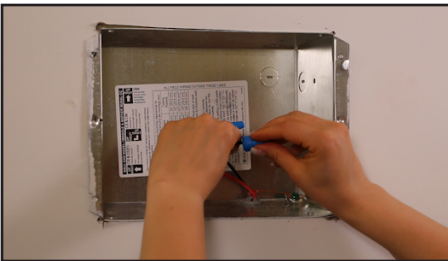

7. Line up the wires from the new heater and twist the wire connectors until tight. Pull each wire to ensure a good connection.

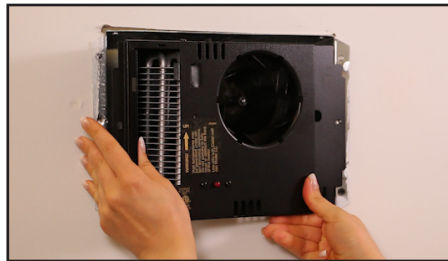

8. Position the heater assembly under the tabs on the wall can on the right side. Secure it using the screw on the left side.



9. Install the front grill using the screw.

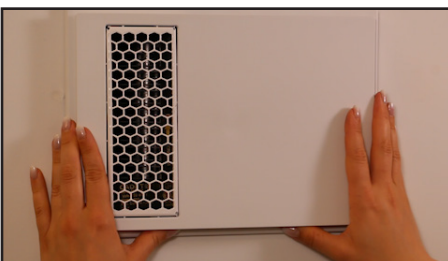

10. Place the cover.



11. Once the installation is complete, turn on the power.

